

Legend

- Noise Monitoring Station
- Air Monitoring Station
- ▲ Real-time Noise Monitoring Station

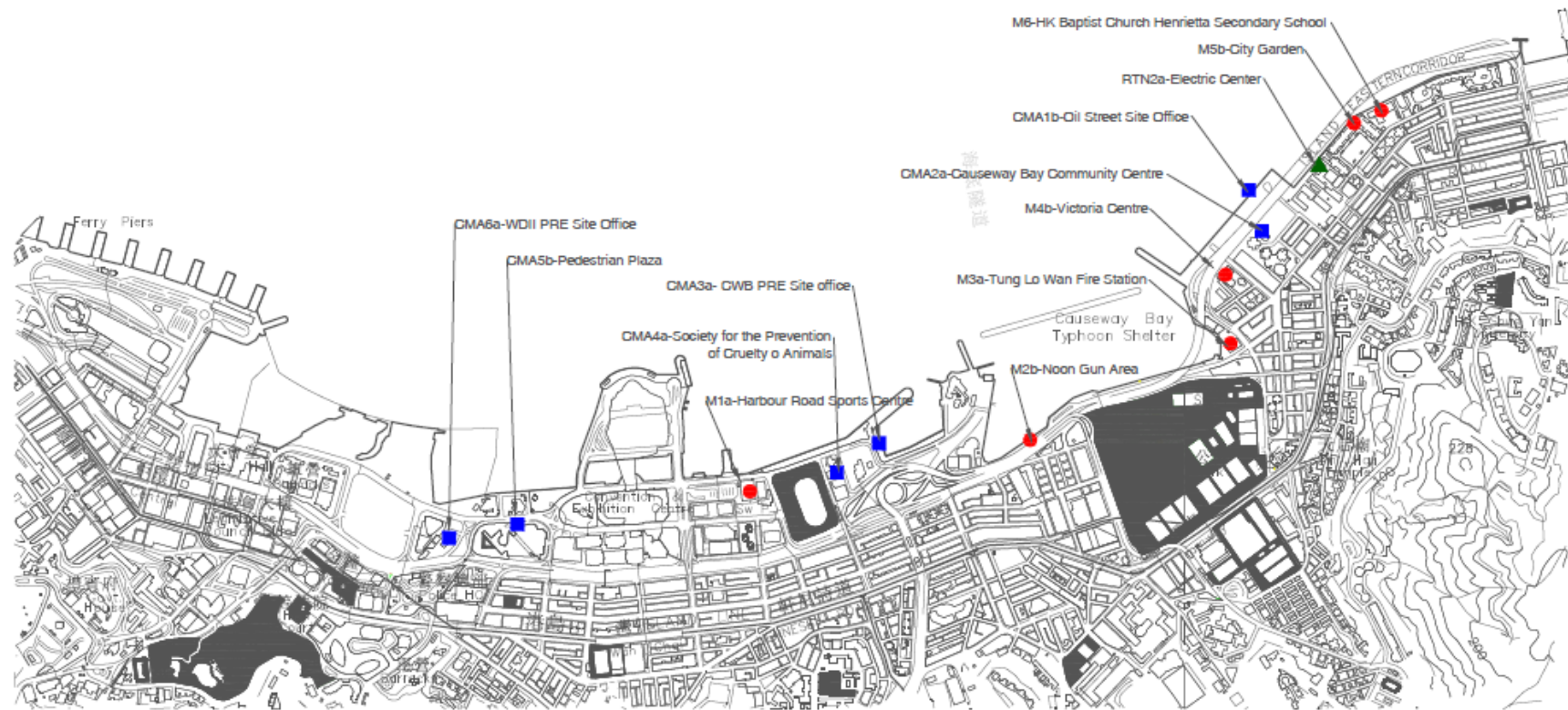

LOCATIONS OF ENVIRONMENTAL MONITORING STATIONS

Legend

● Enhanced DO Monitoring Station

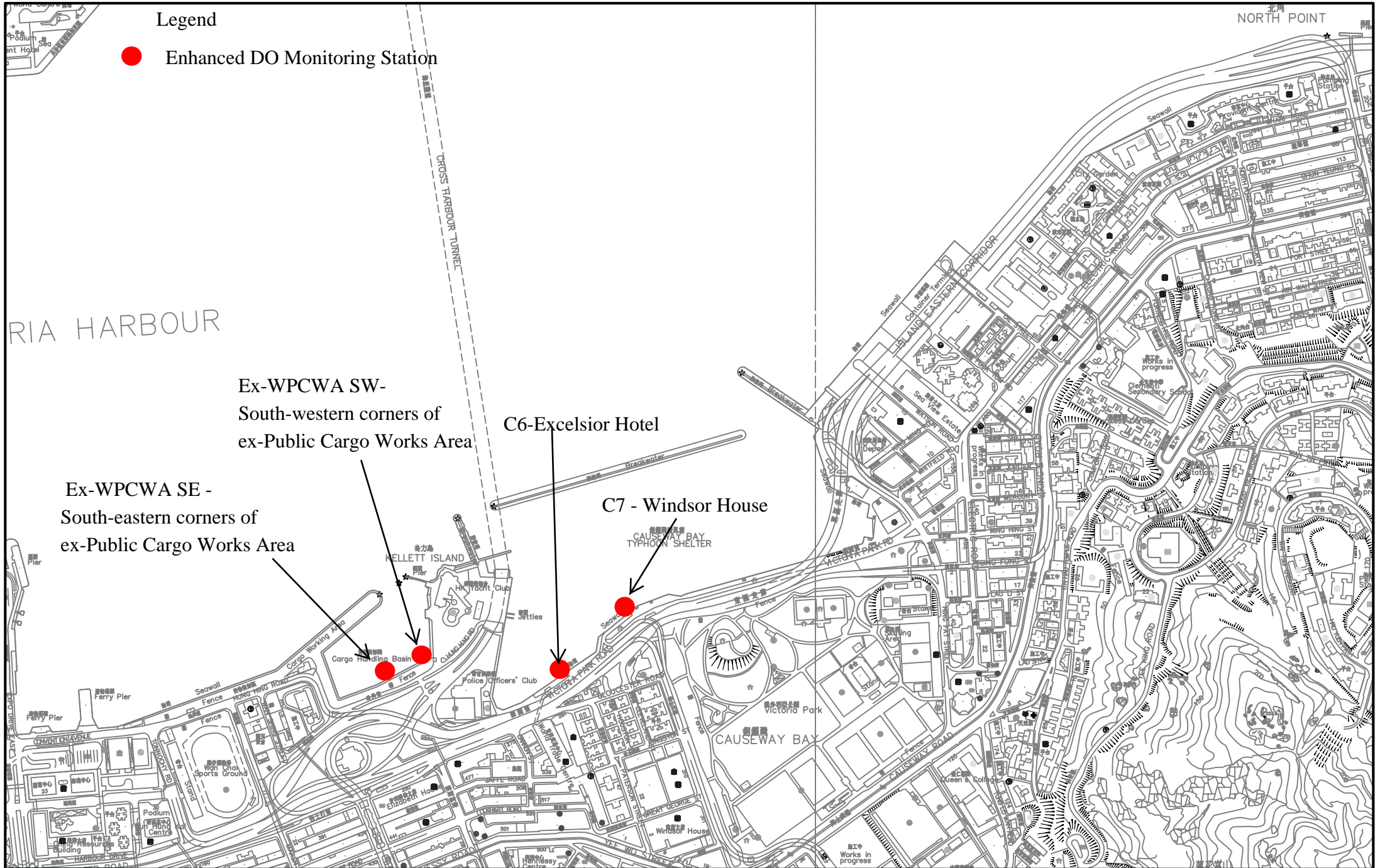

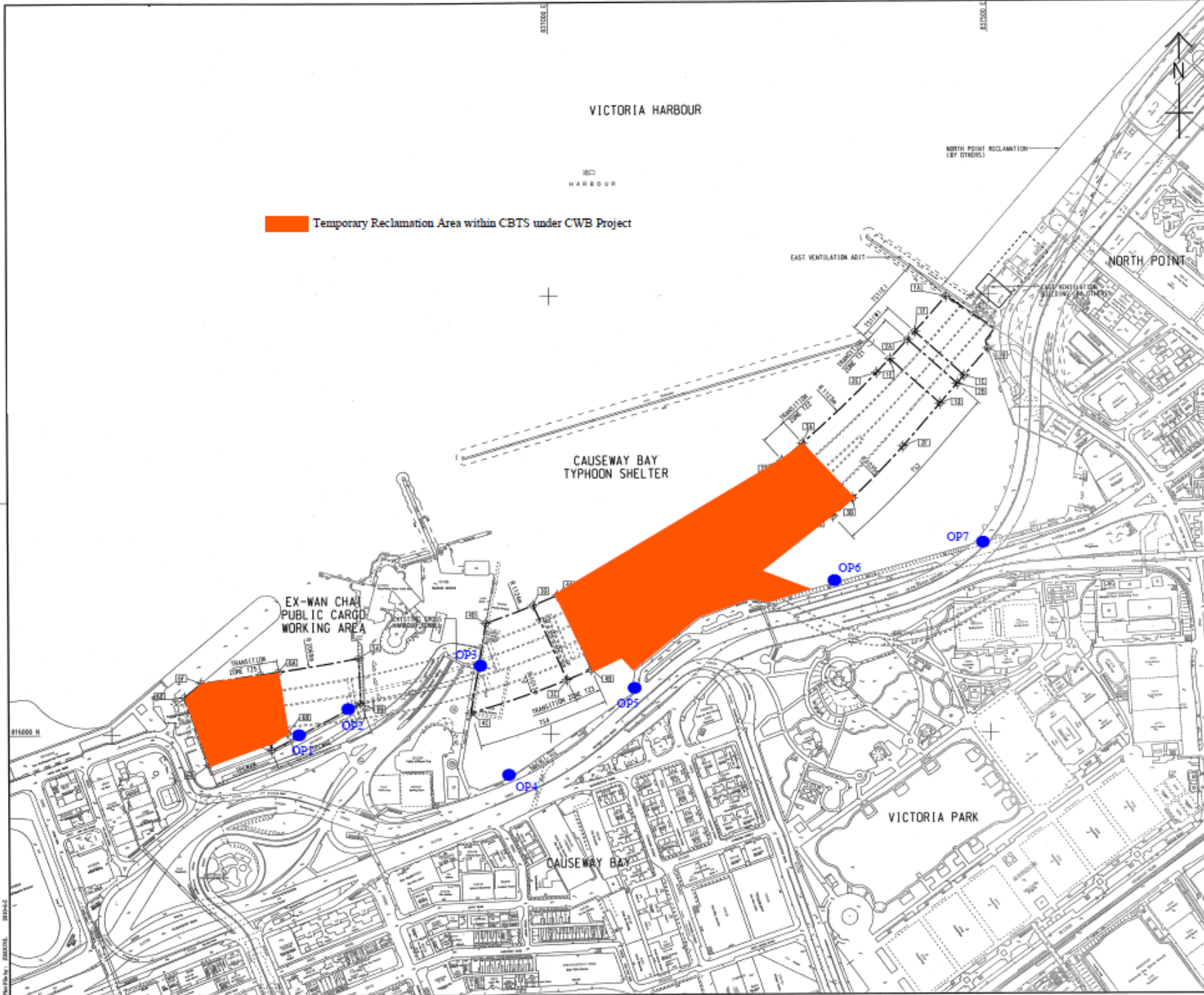

Temporary Reclamation Area within CBTS under CWB Project



KEY PLAN
SCALE A3 1 : 5000
A3 1 : 10000

- Remarks:
1. With respect to the temporary reclamation undertaken within Ex-PCWAW area, the odour monitoring station OP1 is finely adjusted to temporary embayment area at the Enhance DO monitoring station to monitor for the potential odour nuisance in the area.
 2. With respect to the temporary reclamation undertaken within CBTS, the odour monitoring station OP6 was finely adjusted to east of temporary reclamation zone for odour monitoring

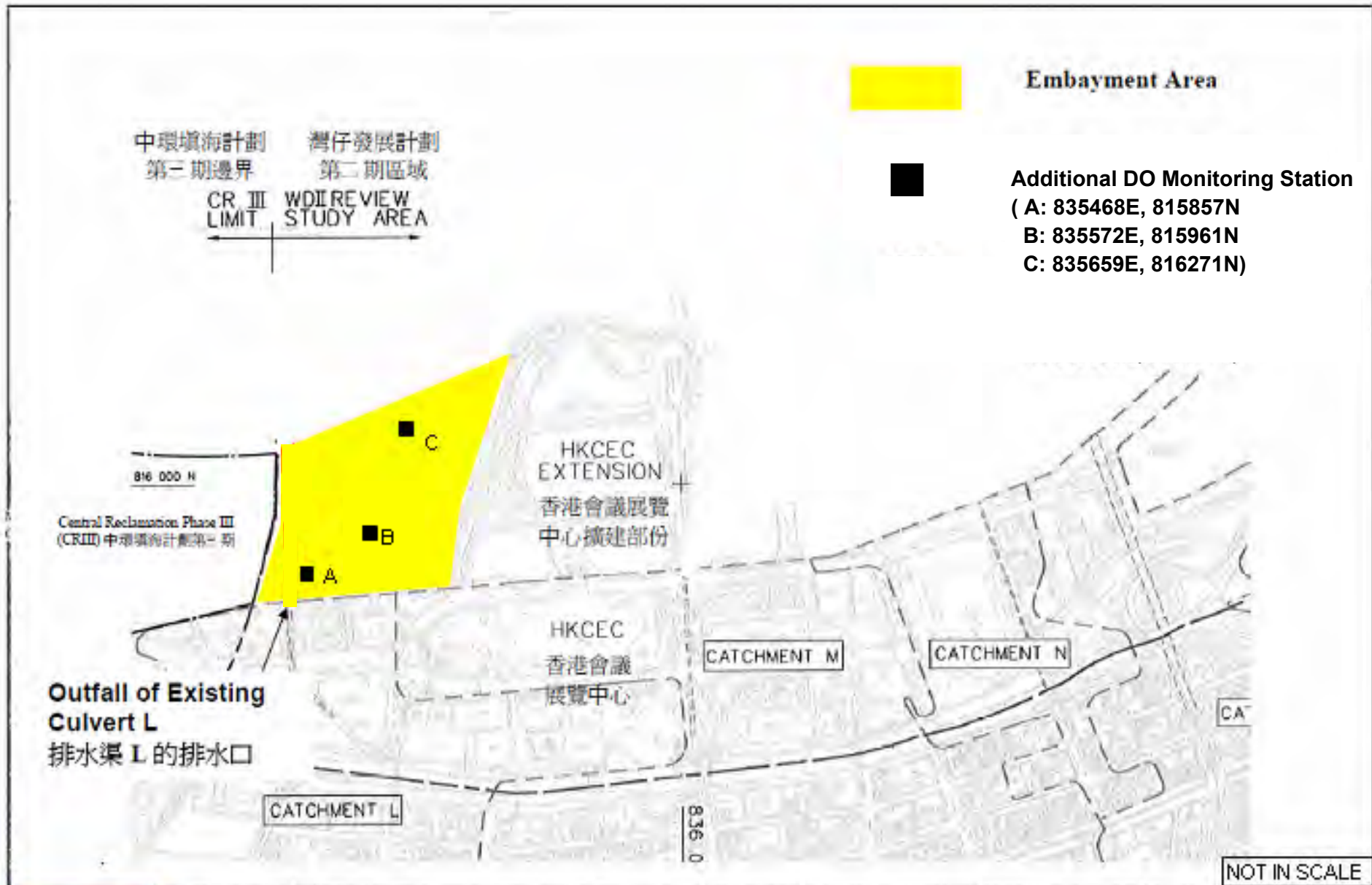

Location Plan of Additional Dissolved Oxygen Monitoring Stations for Culvert L Water Discharge Flow

Legend

- ◆ Water Quality Monitoring Stations
- C1 Hong Kong Convention and Exhibition Centre Extension
- C2 Telecom House/ HK Academy For Performing Art/ Shui On Centre
- C3 Hong Kong Convention and Exhibition Centre Phase 1
- C4 Wan Chai Tower and Great Eagle Centre
- C5 Sun Hung Kai Centre
- C6 Proposed Exhibition Station/ World Trade Centre
- C7 Windsor House
- C8 City Garden
- C9 Provident Centre

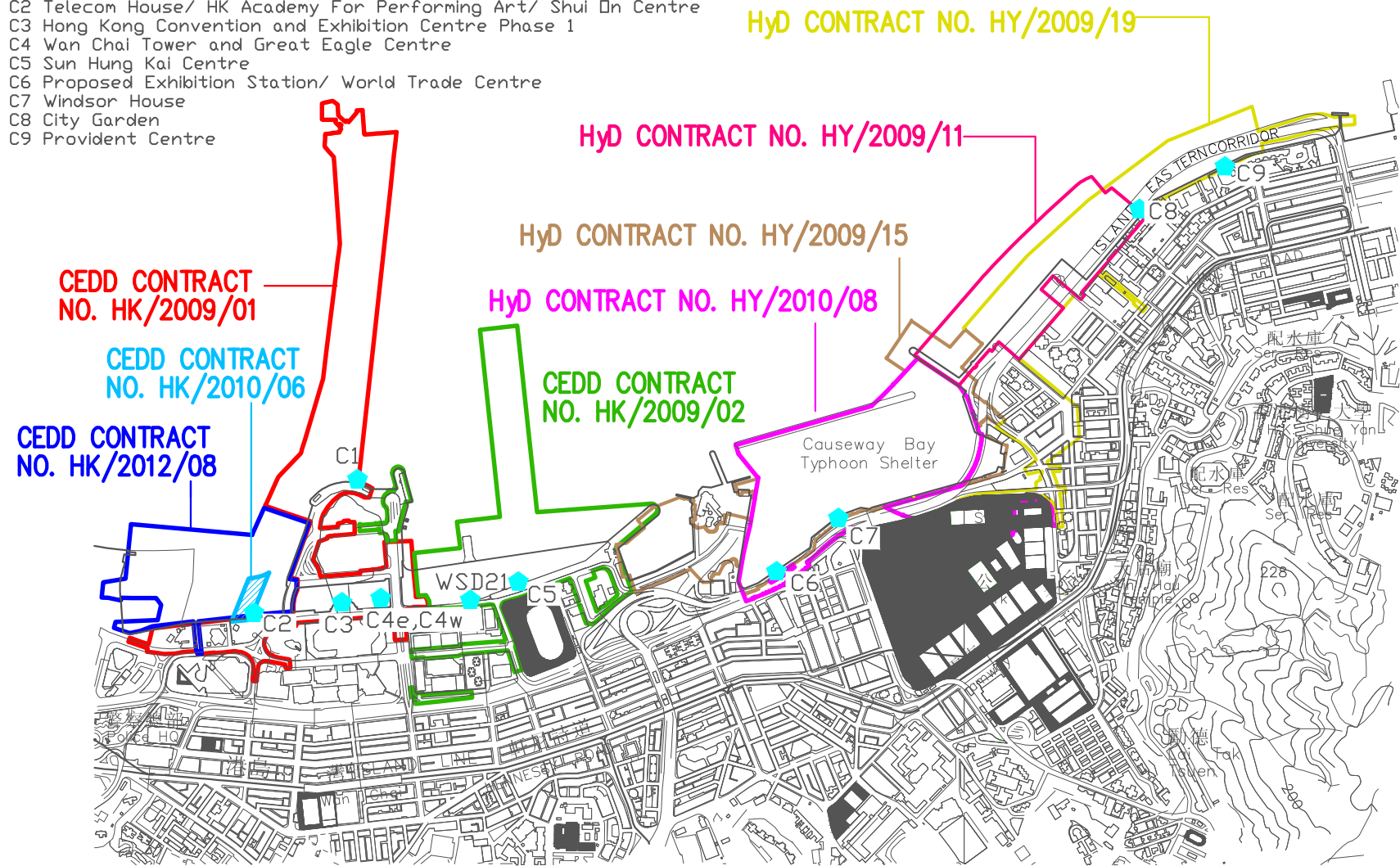

LOCATIONS OF WATER QUALITY MONITORING STATIONS

Legend

- ◆ Water Quality Monitoring Stations
- RW21-P789 (Wanchai WSD intake/ Great Eagle Centre/ China Resources Centre/ Sun Hung Kai Centre)
- C1 Hong Kong Convention and Exhibition Centre Extension
- P1 Hong Kong Convention and Exhibition Centre Phase 1
- P3 HK Academy For Performing Art
- P4 Shui On Centre
- P5 Government buildings (Wanchai Tower/ Revenue Tower/ Immigration Tower)
- C6 Proposed Exhibition Station/ World Trade Centre
- C7 Windsor House

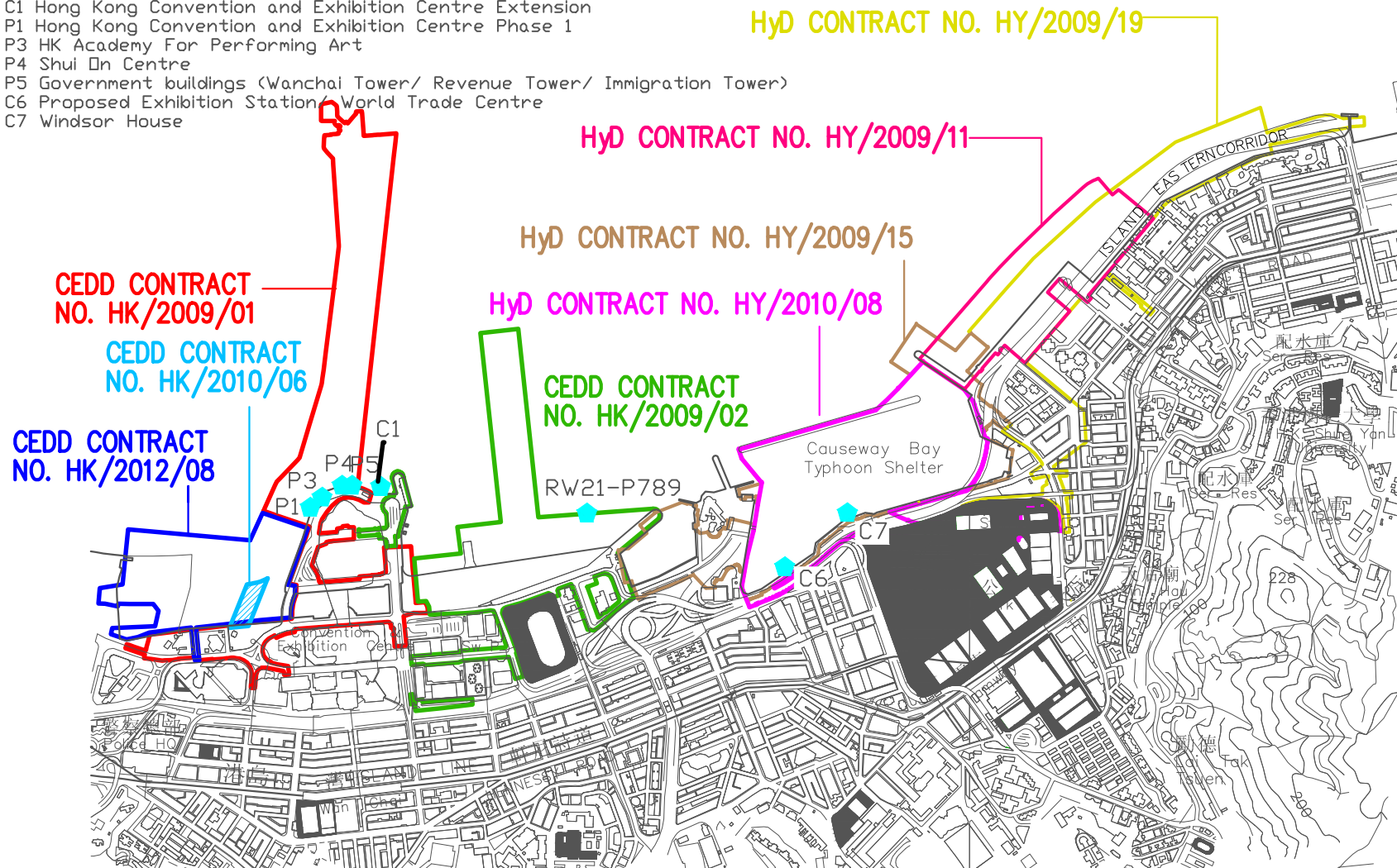

LOCATIONS OF WATER QUALITY MONITORING STATIONS

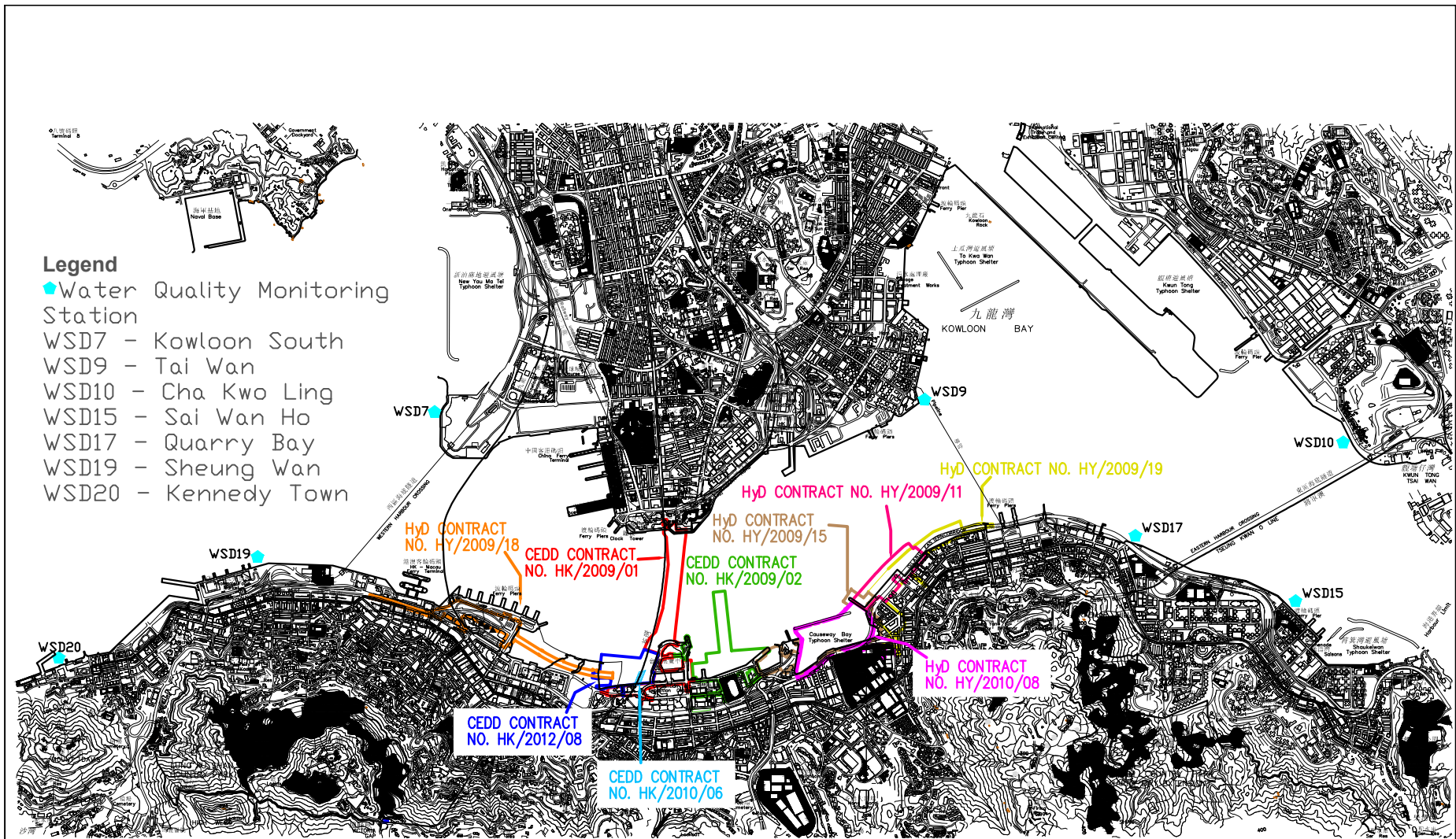

LOCATIONS OF WATER QUALITY MONITORING STATIONS

Legend

- Additional □ Monitoring Station

CEDD CONTRACT
NO. HK/2012/08

CEDD CONTRACT
NO. HK/2010/06

CEDD CONTRACT
NO. HK/2009/01

CEDD CONTRACT
NO. HK/2009/02

HyD CONTRACT
NO. HY/2009/15

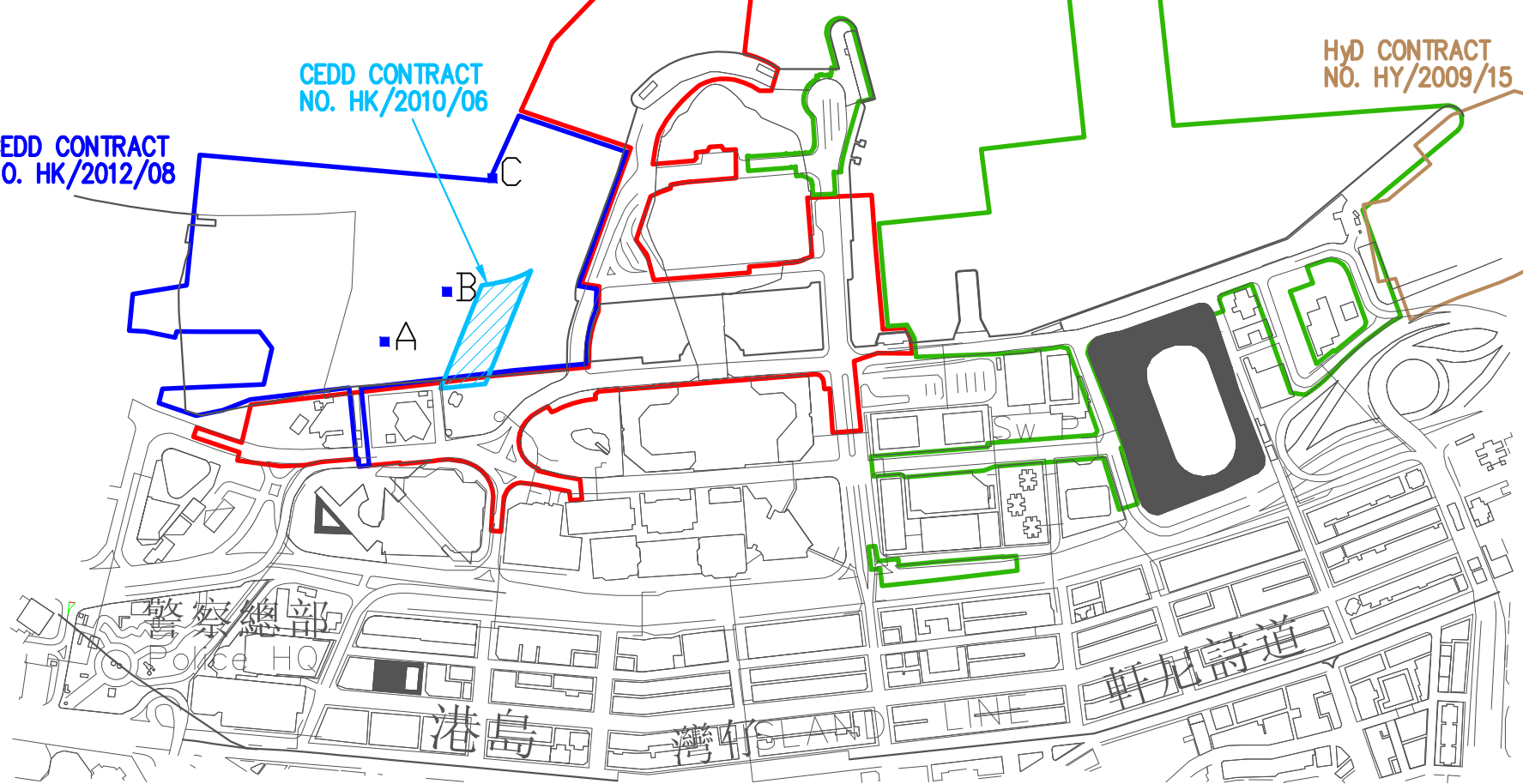

LOCATIONS OF ADDITIONAL DISSOLVED OXYGEN MONITORING STATIONS FOR CULVERT L WATER DISCHARGE FLOW